



4N PRODUCTS **TAPPING BANDS**



Personalised service, distribution across Australia, New Zealand and Asia Pacific regions with a comprehensive product range to match, you're in expert hands.



TABLE OF CONTENTS

Tapping Bands	1
Advantages	2
Installation	3
Tapping Bands Series 1	4
Tapping Bands Series 2	5
Tapping Bands HDPE	6
Notes	7



4N PRODUCTS



DAEMCO AUSTRALIA



DAEMCO AUSTRALIA



DAEMCO AUSTRALIA

TAPPING BANDS WITH SIZES FROM DN40 TO DN300, WITH OPERATING PRESSURES UP TO PN 16.



The 4N Products range of tapping bands are manufactured and certified to Australian and New Zealand standards. They are suitable for potable water, recycled water, irrigation and below ground installations. Colour coded for easy identification for Potable Water, Recycled Water and HDPE. Suitable for use on AC, DICL, PVC and HDPE pipes, pressure and non-pressure applications.

Advantages of the 4N Tapping Band

- Quick and easy to install
- Colour coded for identification
- Positive stop to prevent overtightening
- Superior corrosion protection



1	TOP HALF TAPPED	Noryl
2	RE-ENFORCEMENT BOSS RING	Stainless Steel 316
3	BOTTOM HALF	Noryl
4	BOLTS	Stainless Steel 316
5	E-LIP/O-RING SEAL	Rubber EPDM
6	NUTS	Stainless Steel 316, Molybdenum Delta Seal
7	WASHERS	Stainless Steel 316

Installation of the 4N Tapping Band

- Quick and easy to install
- Positive stop to prevent overtightening

1. Prepare the area of the pipe to be covered by the tapping bands by removing all dirt and loose materials.
2. Position the bottom half of the tapping band making sure it's away from scored, pitted or damaged areas, as this will not provide a good sealing area.
3. Fit the top of the tapping band around the pipe so that the bolts pass through the bolt holes in the top of the tapping band.
4. With one hand underneath the bottom half of the tapping band pressing upwards, locate the bolt holes and screw on the nuts supplied with the other hand.
5. Finger tighten the nuts so that the gap between the two halves of the tapping bands is equal on both sides.
6. Tighten the nuts to 15ft/lbs (20Nm). After 20 minutes re-torque the bolts to the appropriate value of 10ft/lbs (15Nm).

When installing tapping bands with "O" Ring or E-Lip seals, make sure the seal is in the correct position. When fitting curved E-Lip seals position the lug into the matching notch in the band groove to ensure they are aligned correctly. The seal should be placed in the sealing groove, if the seal is placed in the incorrect position the joint may leak.

7. Take-off fittings require no more than three wraps of thread tape to be applied to the full length of the male thread.
8. Take-off fittings need to be tightened to 20ft/lbs (30Nm), and Ferrules must not be screwed in beyond their thread depth. Hand tight plus a half to full turn with a wrench is all that is necessary.
9. Service pipes should be oriented so that no undue leverage is exerted on the band.
10. Tap the pipe through the band being careful not to damage the band nor force swarf under the seal. It is good practice to mark the pipe so that if the band is removed for any reason it may be replaced exactly and centrally over the tapped hole.

Note: If any movement of the system is likely to occur through soil subsidence, water hammer, expansion etc, suitable precautions to prevent such forces moving the bands must be taken, eg. thrust blocks.

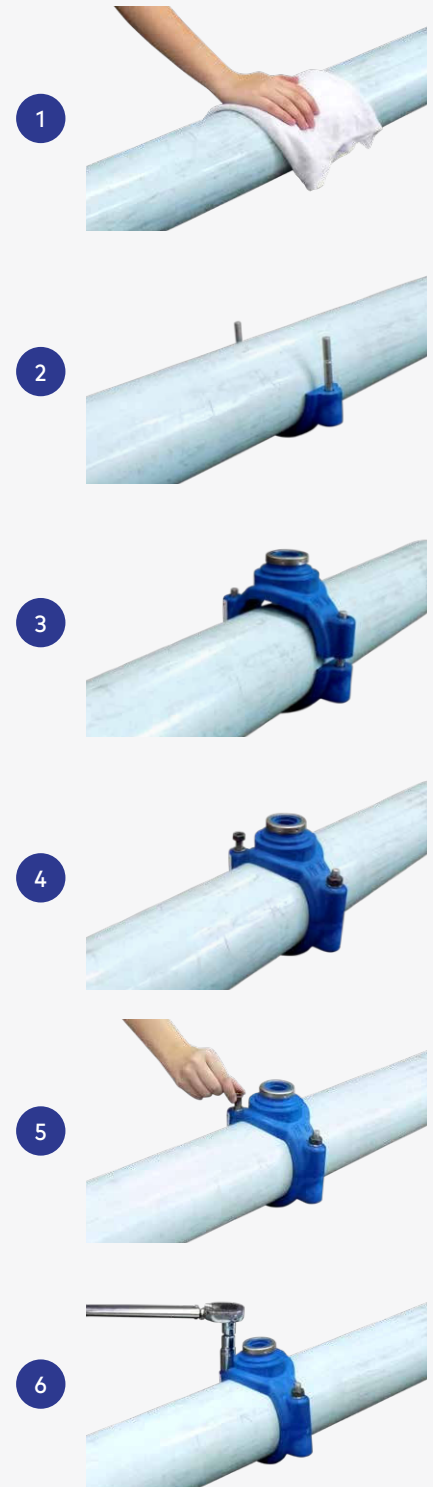

SERIES 1 TAPPING BANDS

Design Advantage

- Quick and easy installation
- Positive stop to prevent overtightening
- Superior corrosion protection

Technical Detail

Range	DN40 to DN300
Pressure	PN16
Temperatures	40°C
Applications	Irrigation, Commercial Plumbing
Pipe Material	PVC-U
Colours	White

Compliance

- AS/NZS4793 Licence ACS 3004
- WSAA PA 1018

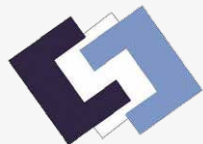

SUITABLE FOR - PVC-U

DN	OD (mm)	E-LIP SEAL ORO-RING	TAPPING SIZE (BSP)				
			20mm (3/4")	25mm (1")	32mm (1 1/4")	40mm (1 1/2")	50mm (2")
40	48	O-Ring	✓	✓	-	-	-
50	60	O-Ring	✓	✓	-	-	-
80	89	E-Lip	✓	✓	✓	✓	✓
100	114	E-Lip	✓	✓	✓	✓	✓
150	160	E-Lip	✓	✓	✓	✓	✓
155	168	O-Ring	-	✓	-	-	✓
195	218	O-Ring	-	✓	-	-	✓
200	225	E-Lip	✓	✓	✓	✓	✓
300	315	E-Lip	✓	✓	✓	✓	✓

SERIES 2 TAPPING BANDS

Design Advantage

- Quick and easy installation
- Positive stop to prevent overtightening
- Superior corrosion protection



Technical Detail

Range	DN100 to DN300
Pressure	PN16
Temperatures	40°C
Applications	Potable Water, Recycled Water
Pipe Material	PVC-M, PVC-O, Ductile Iron, Asbestos Cement
Colours	Blue and Purple



Compliance

- AS/NZS4793 Licence ACS 3004
- WSAA PA 1018

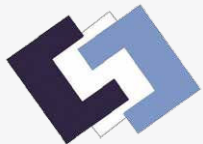

SUITABLE FOR - PVC-M, PVC-O, DUCTILE IRON, ASBESTOS CEMENT PIPE

DN	OD (mm)	E-LIP SEAL OR O-RING	TAPPING SIZE (BSP)				
			20mm (3/4")	25mm (1")	32mm (1 1/4")	40mm (1 1/2")	50mm (2")
100	122	E-Lip	✓	✓	✓	✓	✓
150	177	E-Lip	✓	✓	✓	✓	✓
200	232	E-Lip	✓	✓	✓	✓	✓
225	259	E-Lip	✓	✓	✓	✓	✓
250	286	E-Lip	✓	✓	✓	✓	✓
300	345	E-Lip	✓	✓	✓	✓	✓

HDPE TAPPING BANDS

Design Advantage

- Quick and easy installation
- Positive stop to prevent overtightening
- Superior corrosion protection



Technical Detail

Range	DN63 to DN315
Pressure	PN16
Temperatures	40°C
Applications	Irrigation, Potable Water, Recycled Water
Pipe Material	HDPE 100
Colours	Black and Purple



Compliance

- AS/NZS4129 Licence ACS 3004
- WSAA PA 1019



SUITABLE FOR - HDPE PIPE

DN	OD (mm)	E-LIP SEAL OR O-RING	TAPPING SIZE (BSP)				
			20mm (3/4")	25mm (1")	32mm (1 1/4")	40mm (1 1/2")	50mm (2")
63	63	E-Lip	✓	✓	-	-	-
90	90	E-Lip	✓	✓	✓	✓	✓
110	110	E-Lip	✓	✓	✓	✓	✓
125	125	E-Lip	✓	✓	✓	✓	✓
160	160	E-Lip	✓	✓	✓	✓	✓
180	180	E-Lip	✓	✓	✓	✓	✓
225	225	E-Lip	✓	✓	✓	✓	✓
250	250	E-Lip	✓	✓	✓	✓	✓
315	315	E-Lip	✓	✓	✓	✓	✓



DAEMCO
daemco.com.au 03 9863 6838
2 / 7-9 Clarissa Street, Campbellfield, 3061

**PARTNERING WITH OUR
CUSTOMERS TO DELIVER
END TO END SOLUTIONS**

promains
YOUR PIPELINE PROFESSIONALS



www.daemco.com.au



VALVES



COUPLINGS



ACCESSORIES



PE DI FITTINGS



COVERS



BANDS

65 Assembly Drive, Tullamarine VIC 3043
1800 323 626 | enquiries@daemco.com.au

Follow us on **LinkedIn**

©Copyright 2018. All Rights Reserved. Daemco Australia reserve the right to change designs and specifications without notice, warranties for suitability for use, liability or loss, damage or costs incurred relating to this information is excluded.